

Assembling  
the  
17 inch  
Newtonian  
(Loaner #39)

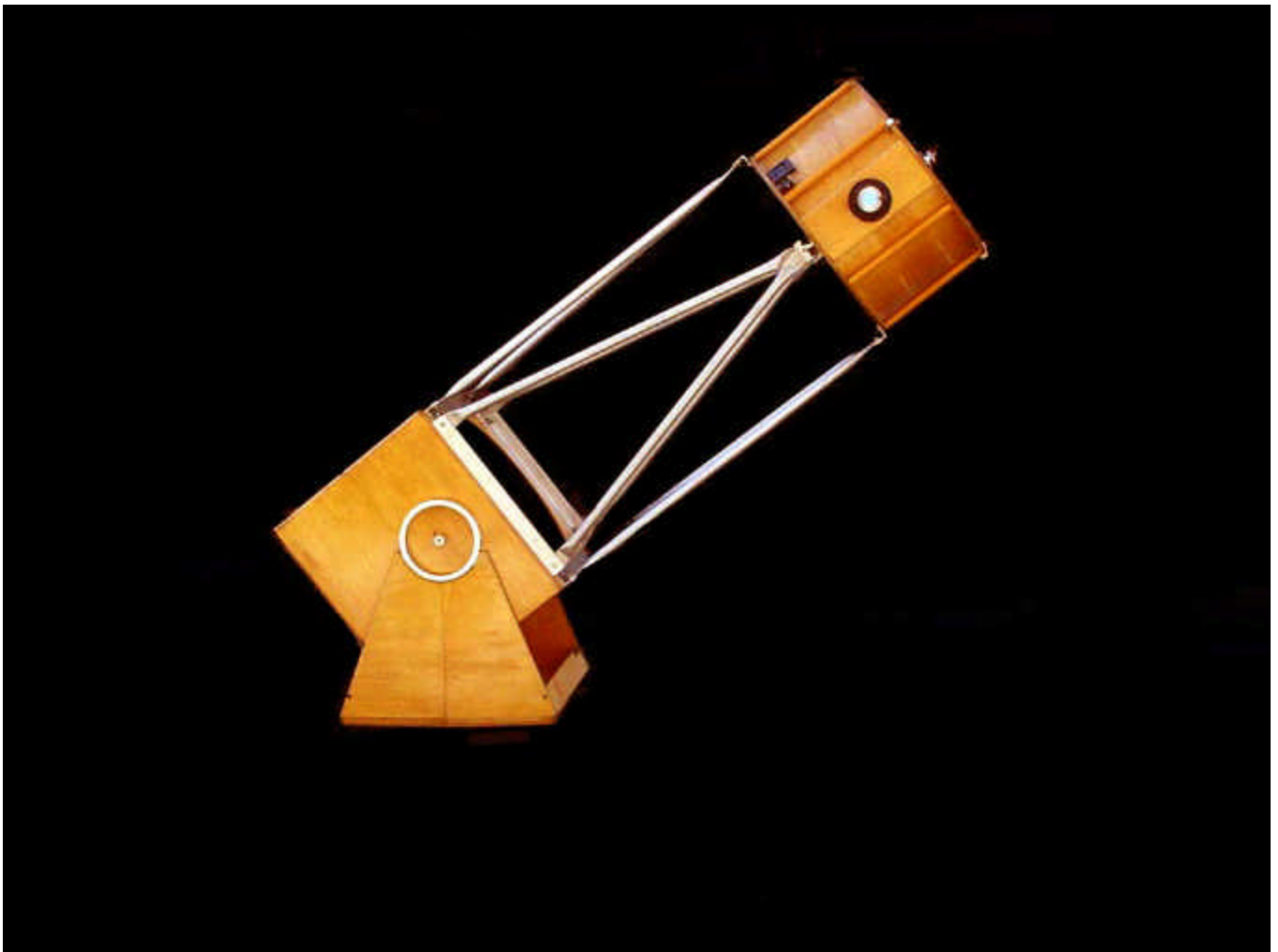

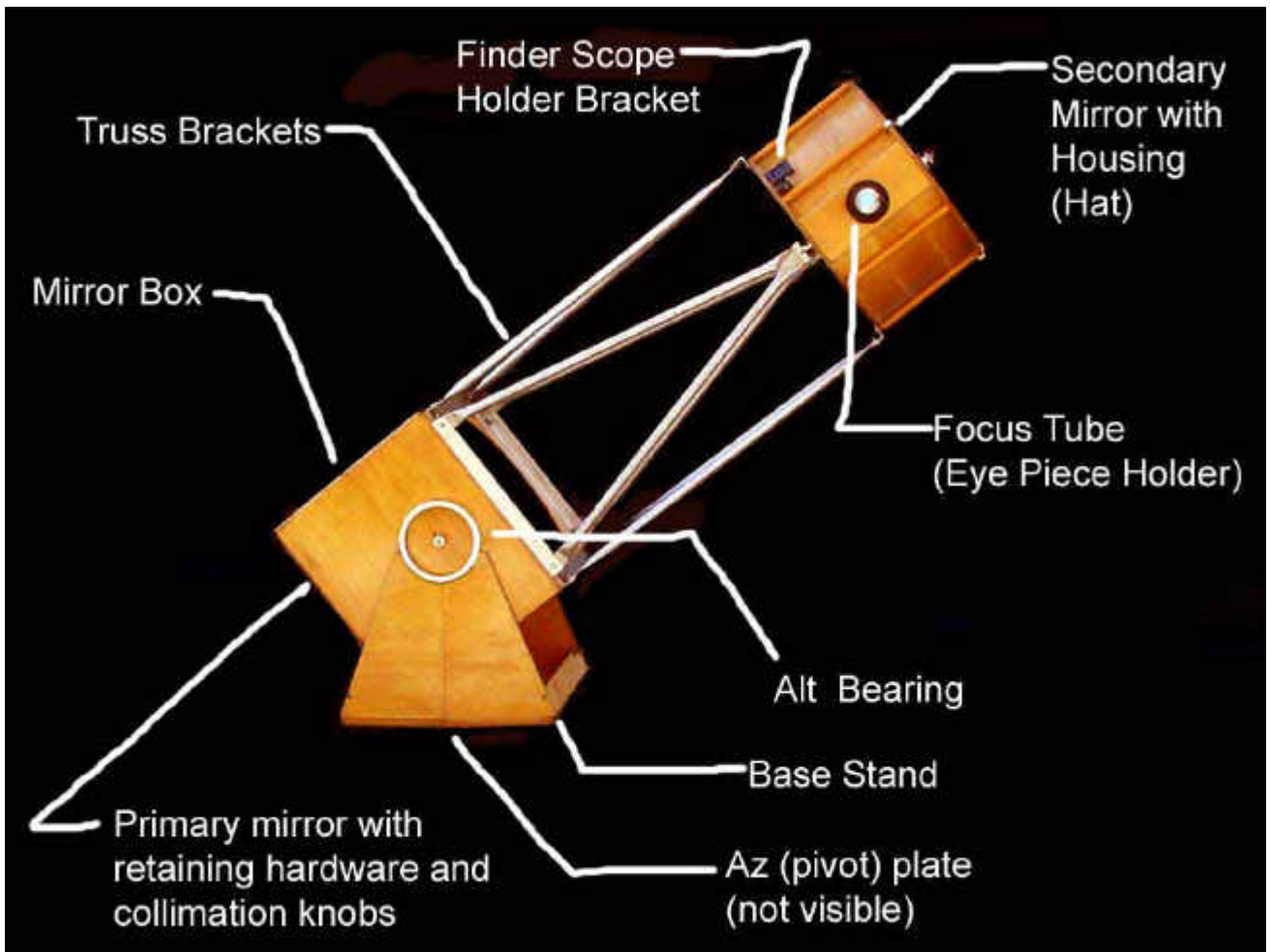

**KEEP THE MIRROR COVER ON DURING  
ASSEMBLY AND DISASSEMBLY!**  
Treat the mirror like you would treat your eye!  
It is delicate!

**KEEP THE MIRROR COVER ON DURING  
ASSEMBLY AND DISASSEMBLY!**  
Treat the mirror like you would treat your eye!  
It is delicate!

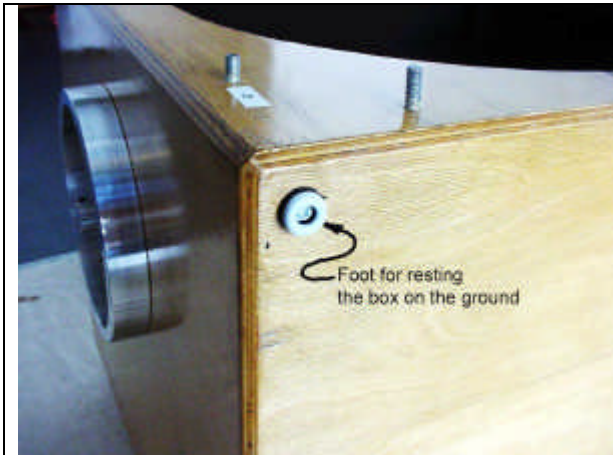

**1** – Place the four plastic feet on the side of the wooden mirror box towards the ground. This should be done on a blanket. Insert three bolts into the holes

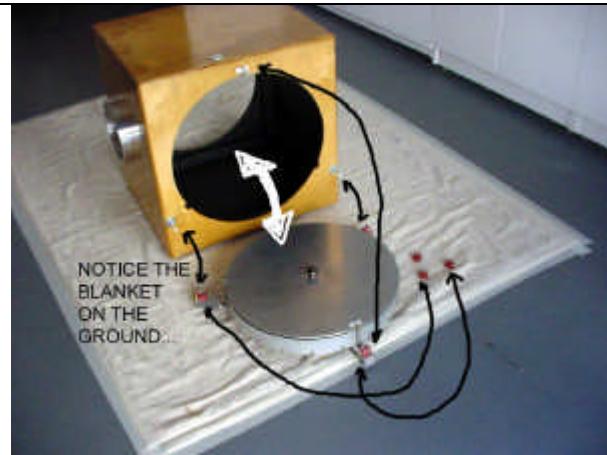

**2**- You'll be installing the primary mirror next. The mirror is heavy and fragile, so read steps 3,4,5,6 before you proceed.

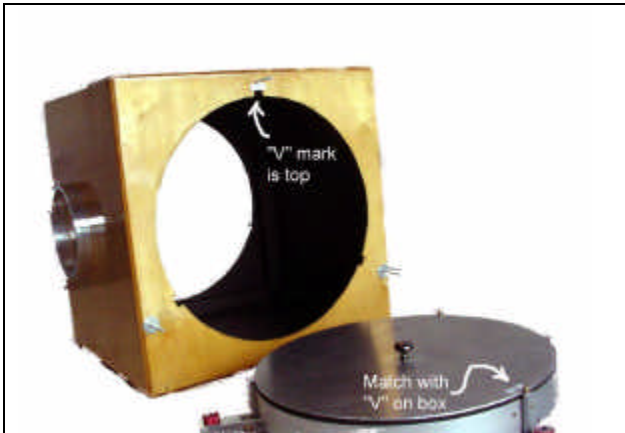

**3**- Notice that the mirror cover and the wooden mirror box have a white adhesive label with the letter "V" on them. You will orient the mirror so that the two "V"s align together.



**4**- Here is a detail of the "V" mark on the box. Notice the mirror's retainer bolts have been inserted. A total of three bolts should be installed – they must be replaced if they become bent.

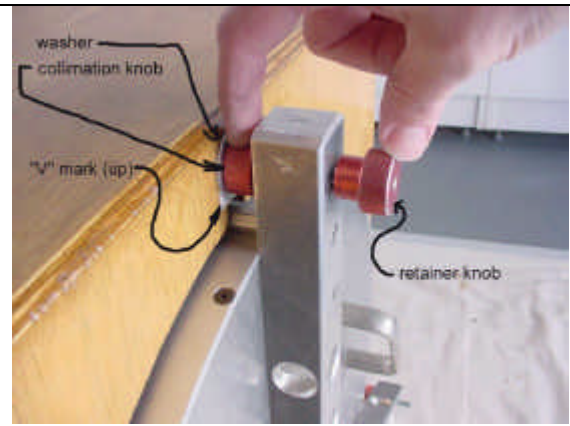

5- Once the mirror is installed and the mirror retainer thumbscrews are in place, this is what the assembly should look like.

6- To adjust collimation, the retainer knob must first be loosened, then turn the collimation knob to reposition the mirror angle. Finger-tighten all three mirror retainer knobs before placing the mirror box on the base.



7- With the mirror installed in the mirror box, place the wooden mirror box onto the assembled base. The triangle base (pivot/bearing) is not visible in this illustration, but is under the base stand.

8- Next you'll add the trusses and the secondary mirror (Hat section). Make sure the mirror cover is still covering the mirror!

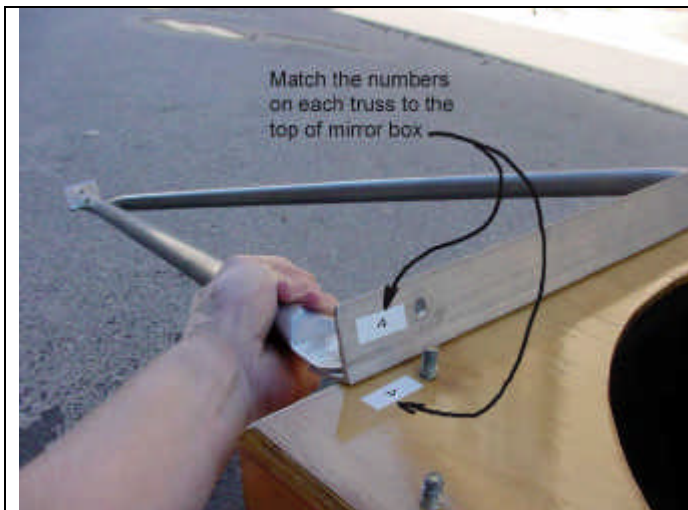

**9-** Notice the top face of the mirror box has numbers 1, through 4 one them, and each truss also has a matching number. Align these numbers face to face (so they kiss one another). Once a truss is in place, secure the truss with a pair of wing nuts – finger tight is fine, NO need to cinch down hard.

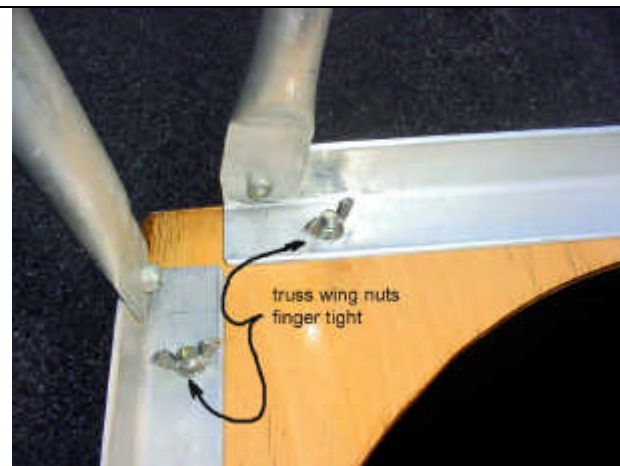

**10-** all four truss brackets are to be secured with wing nuts.



**11-** Install the secondary mirror housing (hat). Secure the hat to the top of the truss brackets with bolts. Squeezing the hat down as you tighten the bolts finger tight is adequate. Generally the focus tube (eye piece holder) is facing one of the two alt bearings (side face of mirror box).



**12-** Attach the finder scope and/or the Rigel finder. You're ready to remove the mirror cover from the primary and secondary mirrors. Collimate and enjoy. The primary mirror cover is held in place with brass nuts and the secondary has a cloth bag. Keep these covers clean and remember to treat the mirrors like you would treat your eyes.

Reverse these instructions for disassembly.